

Hydraulic Transmission Jack

Owner's Manual and
Spare Parts List

0,5 THRU 2 TON
Capacity



VIKING

2170 2175 2180
Models: 1555, 1560, 1570

↑ SUNEX 6652

Important

Please read these instructions carefully before using your jack.

Proper use and care of the jack will help to assure you of continuous, safe, trouble free performance



Catalog Nr 054226

GUILDERLAND, NEW YORK, 12084, USA

T2

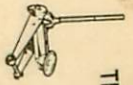

TRI-CITY HYDRAULIC JACK SERVICE
4628 N. Florida Avenue
Tampa, Florida 33603-3700
(813) 236-8551

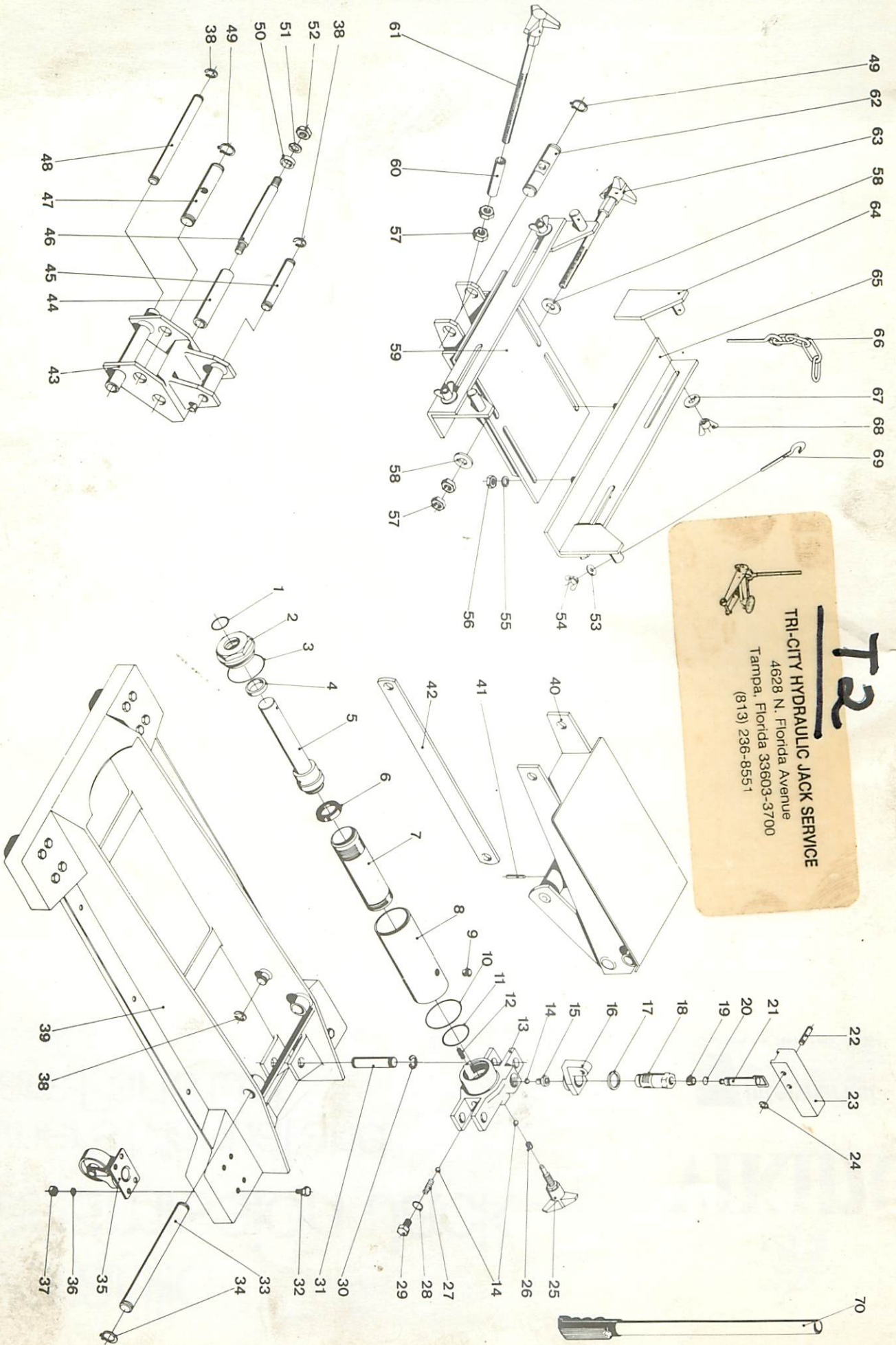

Owner's Manual and Spare Parts List

Issued, April, 1st 1985

REF. NR	PART NAME	PART NR 2175					
		QTY	0,5T-1555	QTY	1,0T-1560	QTY	2,0T-1570
01	O Ring	01	862214	01	862218	01	862218
02	Head Nut	01	981004	01	981010	01	981010
03	O Ring	01	862036	01	862040	01	862040
04	Spacer	01	910211	01	910249	01	910249
05	Lift Piston	01	790006	01	690020	01	790020
05C	Lift Piston Kit (05 and 06)	01	791006	01	691006	01	791020
06	Cup	01	832223	01	832430	01	832430
07	Jacket	01	916006	01	916012	01	916024
08	Reservoir	01	969006	01	969012	01	969024
09	Plug	01	893101	01	893101	01	893101
10	O Ring	01	862036	01	862043	01	862043
11	O Ring	01	862128	01	862137	01	862137
12	Filter	01	828010	01	828010	01	828010
13	Pump Housing	01	907005	01	907006	01	907006
14	Ball	03	824030	03	824030	03	824030
15	Valve	01	991006	01	991006	01	991006
16	Link	01	978004	01	978004	01	978004
17	Spacer	01	905003	01	905003	01	905003
18	Jacket	01	915004	01	915004	01	915004
19	Cup	01	832307	01	832307	01	832307
20	O Ring	01	862012	01	862012	01	862012
21	Plunger	01	789005	01	789005	01	789005
21C	Plunger Kit (19 thru 21)	01	789006	01	789006	01	789006
22	Axle	02	927044	02	927044	02	927044
23	Socket	01	929005	01	929005	01	929005
24	Track Ring	04	804006	04	804006	04	804006
25	Release Screw	01	788005	01	788005	01	788005
26	Packing	01	883205	01	883205	01	883205
27	Spring	01	856127	01	856127	01	856127
28	O Ring	01	862204	01	862204	01	862204
29	Plug	01	866409	01	866409	01	866409
30	Track Ring	04	804012	04	804119	04	804119
31	Axle	02	927092	02	927115	02	927115
32	Bolt	16	866210	16	866310	16	866413
33	Axle	01	927114	01	927154	01	927191
34	Track Ring	02	804119	02	804125	02	804131
35	Caster	04	880006	04	880004	04	880007
36	Washer	16	806030	16	806040	16	806050
37	Nut	16	873201	16	873300	16	873401

REF. NR	PART NAME	PART NR 2175					
		QTY	0,5T-1555	QTY	1,0T-1560	QTY	2,0T-1570
38	Track Ring	06	804012	06	804012	06	804015
39	Frame	01	780005	01	780012	01	780022
40	Lift Arm	01	775006	01	775010	01	775020
41	Tension Pin	01	871019	01	871024	01	871024
42	Link	02	983036	02	983037	02	983045
43	Carrier	01	794005	01	794010	01	794020
44	Spacer	01	910134	01	910136	01	910153
45	Axle	01	922703	01	922703	01	922716
46	Axle	01	922705	01	922707	01	922718
47	Axle	01	922735	01	922753	01	922790
48	Axle	01	922704	01	922706	01	922717
49	Track Ring	04	804122	04	804125	04	804131
50	Spacer	02	905004	02	905004	02	905022
51	Washer	02	806070	02	806070	02	806091
52	Nut	02	873501	02	873501	02	873601
53	Washer	02	806031	04	806051	04	806051
54	Nut	02	873202	04	873402	04	873402
55	Washer	04	806050	04	806050	08	806050
56	Nut	04	873401	04	873401	08	873401
57	Nut	04	873501	04	873601	04	873701
58	Washer	02	806071	02	806090	02	806111
59	Saddle	01	770006	01	770010	01	770020
60	Spacer	01	910090	01	910137	01	910154
61	Knob/Tilt Screw	01	788106	01	788107	01	788111
62	Axle	01	922734	01	922752	01	922789
63	Knob/Adjust Screw	01	788105	01	788108	01	788110
64	Claw (Pair)	02	782005	02	782006	02	782007
65	Angle	02	781105	02	781110	02	781120
66	Chain	01	781005	02	781011	02	781020
67	Washer	04	806051	04	806051	08	806051
68	Nut	04	873402	04	873402	08	873401
69	Hook	01	866239	02	956009	02	956009
70	Handle	01	778005	05	778005	01	778005
	Repair Kit (1, 3, 6, 9, 10, 11, 19, 20, 26, 28)		783005		783011		783011
	Hydraulic Unit (01 Thru 29)		797006		797011		797020
	Adapter Kit (43 Thru 69 and 38)		770007		770010		770021