

Repair Parts List WA-72-B

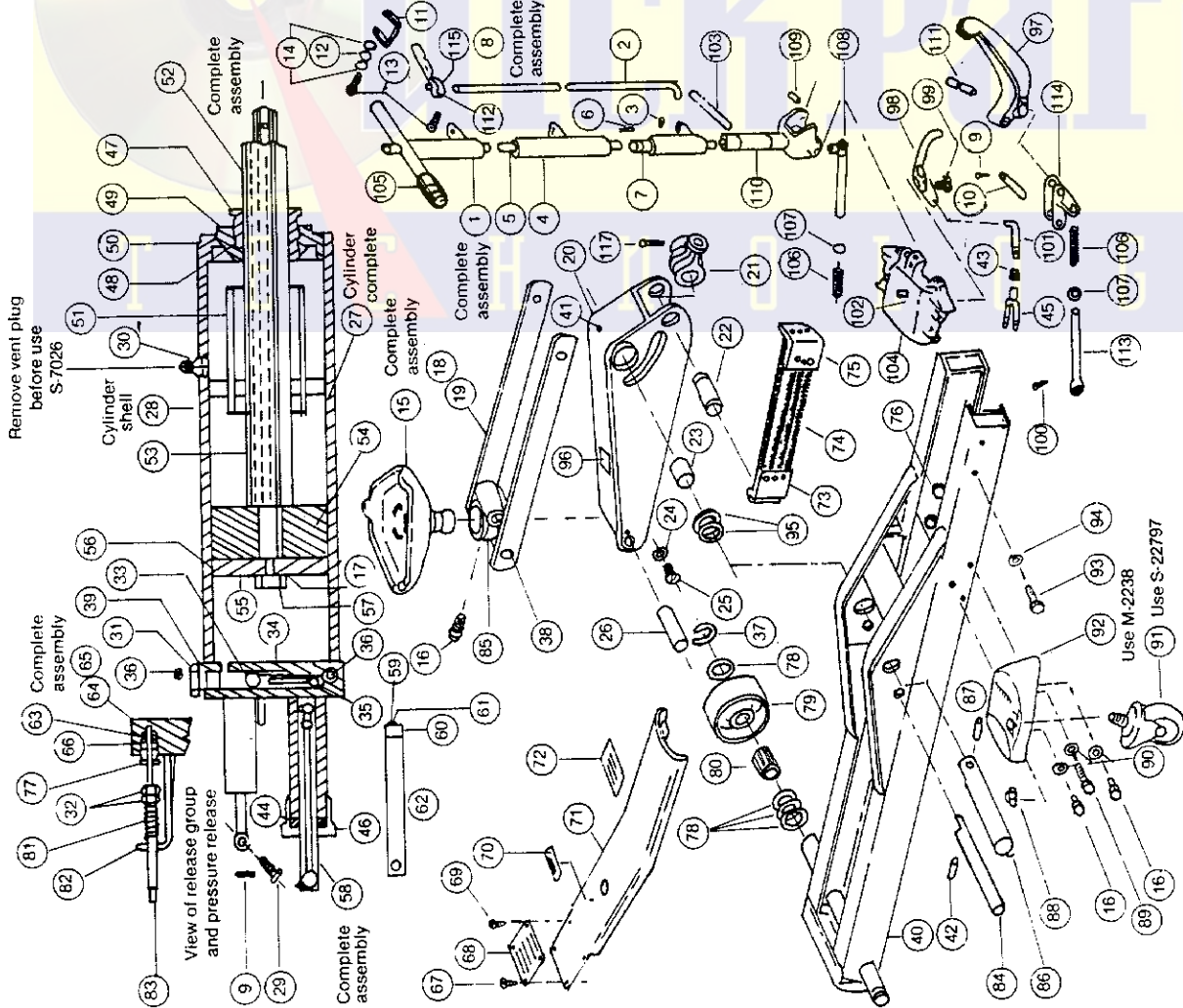

Note (1): Made with two or three spring assembly; see WA-72A for two spring assembly.

Repair Parts List WA-72B

Item No.	Part No.	Description	Qty.
1.	AS-6565	Handle Assembly	1
2.	S-6637	Release Rod	1
3.	S-102	Sq. Hd. Set Screw 3/8x16 x 3/4"	1
4.	AS-5129	Handle	1
5.	AS-6641	Lock Rod	1
6.	S-4074	Cotter Pin 1/16 x 3/4	1
7.	S-1353	Handle Spring	1
8.	AS-22107	Release Handle Assembly	1
9.	S-275	Cotter Pin 1/8 x 3/4	3
10.	S-7299	Pump Plunger Pin	2
11.	S-7075	Release Lock	1
12.	S-13520	Spring Washer	1
13.	S-23872	Sq. Hd. Set Screw 1/4-20 x 3/4	3
14.	S-437	Flat Washer 1/4	2
15.	M-2122	Saddle	5
16.	S-105	Hex Hd. Capscrew 3/8-16 x 1	1
17.	S-3277	Int. Lockwasher 3/8	1
18.	AS-27118	Parallel Link Assembly	1
19.	S-23197	Parallel Link	2
20.	AS-24867	Arm	1
21.	M-1444	Crosshead	1
22.	S-23201	Crosshead Pin	1
23.	S-6576	Bearing	2
24.	S-10189	Int. Lockwasher 3/8	1
25.	S-6655	Rd Hd Mach Scw 1/4-20 x 3/8	1
26.	S-23199	Arm Bracket Pin	1
27.	AS-16145A	Pump & Cyl. Assembly	1
28.	AS-15206A	Pump & Cylinder	1
29.	S-7026	Self-tapping scw No. 4-40 x 1/4	1
30.	S-18071	Drilled Pipe Plug	1
31.	S-9309	Ball Chamber Plug	1
32.	S-1863	Jam Nut 3/8 x 16	2
33.	S-2750	Ball 1/2"	1
34.	S-7229	Ball Weight	1
35.	S-2505	Ball 5/16"	1
36.	S-1806	Pipe Plug 3/16	4
37.	S-25462	Retainer Ring	2
38.	S-23198	Parallel Rivet Pin	1
39.	S-2594	Ball Chamber Gasket	2
40.	AS-23202A	Frame	4
41.	S-7452	Front Whhd. Bearing	4
42.	S-12617	Spacer (N/A)	1
43.	S-1087	Roll Pin 3/16 x 1	1
44.	S-7492	Hex Nut 5/16-24	3
45.	S-5123	Plunger Packing	1
46.	M-1769	Release Clevis	1
47.	S-15203	Plunger Packing Nut	1
48.	S-6654	Piston Packing Nut	3
49.	M-2018	Cylinder Cap	2
50.	S-22961	Gasket	1
51.	S-26235	Piston Rod Stop	1
52.	AS-66333	Ram Head Assembly	1
53.	S-6633	Piston Rod	1
54.	M-2165	Ram Head	1
55.	S-6016	Ram Cup	1
56.	S-6009	Back-up Washer	1
57.	S-7573	Hex Nut 3/8-24	1
58.	AS-7443A	Pump Plunger Assembly	1
59.	S-7444	Pump Nut	1
60.	S-7265	Pump Cup	1
61.	S-7050	Washer 17/64 ID x 15/32 OD	1
62.	S-7443	Pump Plunger	1
63.	AS-21052	Packing Assembly	1
64.	S-17829	O-Ring	1
65.	S-21051	Packing Housing	1
66.	S-15047	O-Ring	1
67.	S-12660	Rd. Hd. Self-Tapping Screw 10-32 x 3/8	2
68.	S-23225	Nameplate	1
69.	S-2579	Drive Screw 4 x 5/16	2
70.	S-24747	Gov't Label	1
71.	S-23235	Cover	1
72.	S-21023	Caution Label	1
73.	S-22747A	Lg. Spring Clip	1
74.	S-16061	Sm. Spring Clip	6
75.	S-22746A	Hex. Nut 3/8-16	6
76.	S-595	Release Packing Nut	8
77.	S-5176	Washer 1-1/32 ID x 1-3/4 OD	2
78.	S-889	Front Wheel	2
79.	M-2271	Cage Roller	2
80.	S-23194	Release Valve Spring	1
81.	S-2591	Release Valve Guide	1
82.	S-5173	Release Valve Plunger	1
83.	S-21049A	Parallel Link	1
84.	S-23196	Saddle Bracket	1
85.	M-2247	Lifting Arm Pin	1
86.	S-23195	Roll Pin	1
87.	S-22770	Acorn Nut	2
88.	S-8542	Hx Hd Cap Scw 3/8-16 x 1-1/4	2
89.	S-944	Lockwasher 3/8"	6
90.	S-1325	Caster	2
91.	S-22797A	Caster Bracket	2
92.	M-2238	Hx Hd Cap Scw 1/2-13 x 1-3/4"	4
93.	S-700	Lockwasher 1/2"	4
94.	S-1571	Flatwasher 2 OD x 1-9/32 ID x 1/16	4
95.	S-26803	Weaver Decal	1
96.	S-23739	Foot Lever	1
97.	M-1450	Release Lever	1
98.	M-1417	Release Lever Pin	1
99.	S-6560	Cotter Pin 1/8 x 1	1
100.	S-107	Release P-ill Rod	1
101.	S-6658A	Roll Pin 3/16 x 1-1/4	1
102.	S-15035	Handle Pin	1
103.	S-6629	Tile Casting	1
104.	M-2246	Handle Grip	2
105.	S-20886	Handle Return Spring	2
106.	S-6623	Washer 13/32 ID x 13/16 OD	1
107.	S-19909	Handle Rod	1
108.	AS-27335	Handle Rivet	1
109.	S-6636	Handle Rivet	1
110.	M-1442	Foot Lever Pin	1
111.	S-6627	Roll Pin 1/4 x 1/2	1
112.	S-23689	Pump Link Rod	1
113.	S-23192	Pump Link	1
114.	M-2245	Release Handle	1
115.	M-1157	Cotter Pin 1/4 x 2-1/4	2
116.	S-2499	Cotter Pin 3/16 x 2	2
117.	S-3234		