

WA-140B Trans.

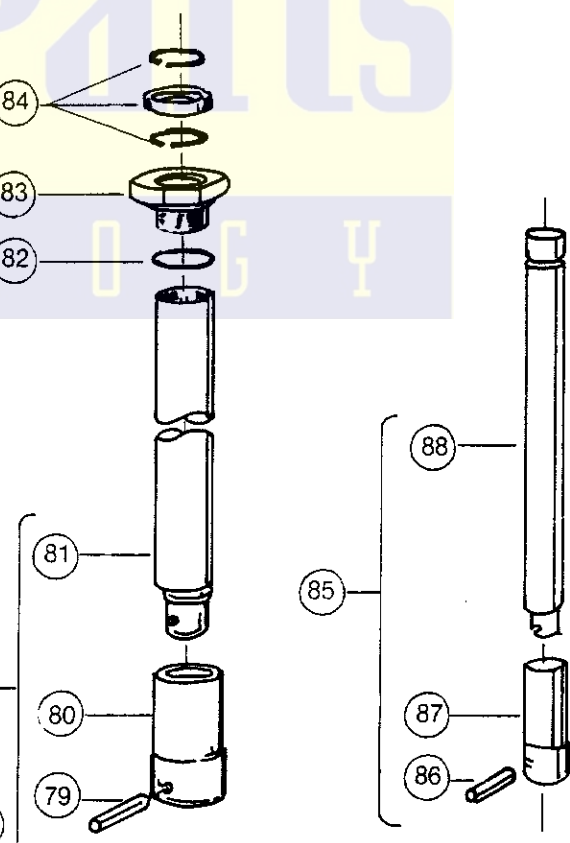
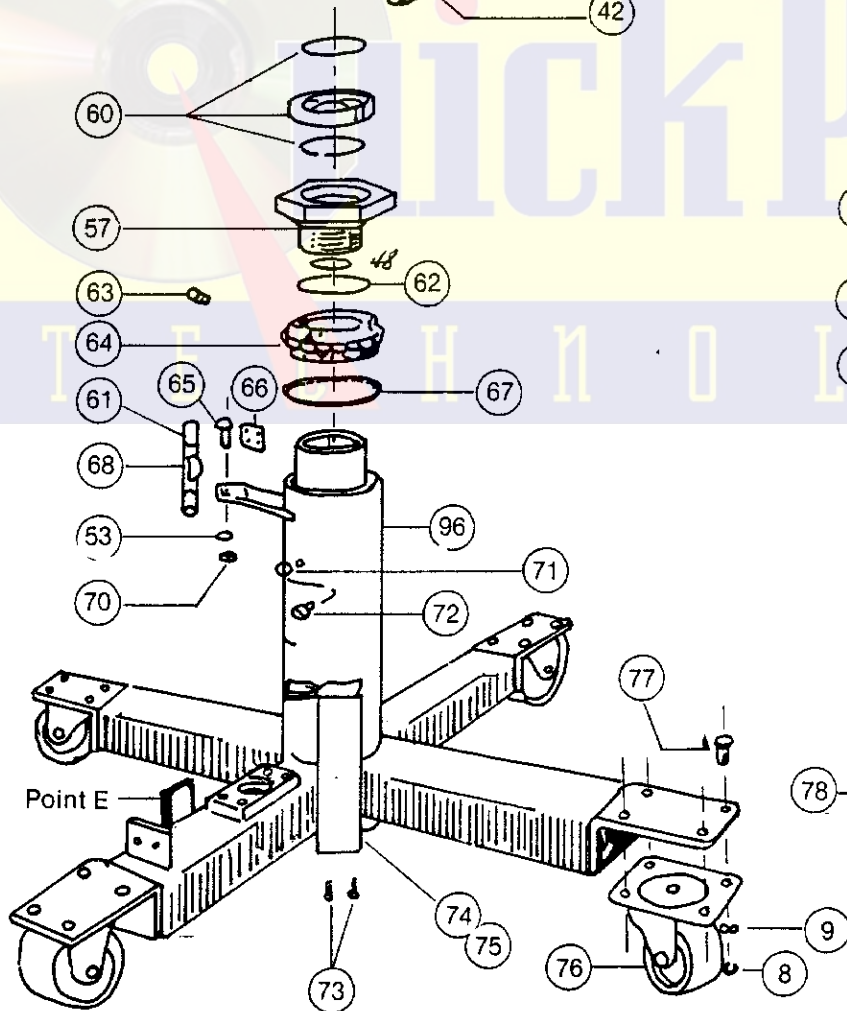
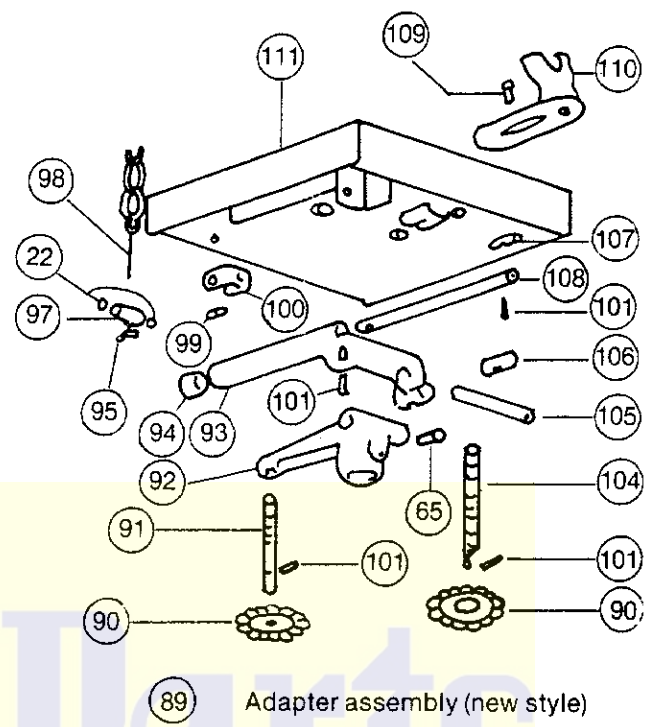
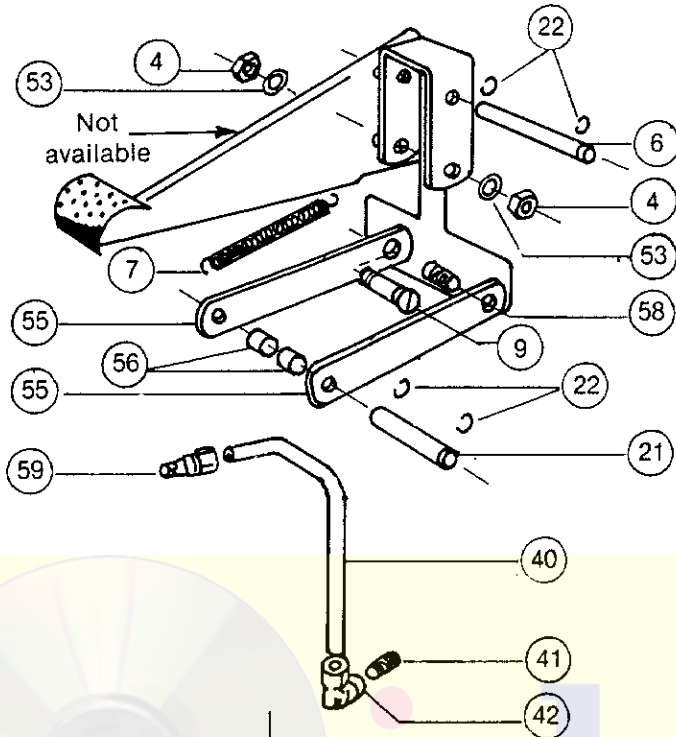

## Repair Parts List WA-140B

Item No.	Part No.	Description	Item No.	Part No.	Description
1.	S-17000	Pump Cover	57.	M-2196	Lower Collar
2.	S-6655	Rd. Hd. Machine Screw 1/4-20	58.	S-17385	Link Pin
3.	AS-17397	Foot Pedal Assembly	59.	S-2612	Connector
4.	S-7573	Hex Nut 3/8-24	60.	S-20620	GT Ring
5.	S-12774	Snap Ring	61.	S-20886	Handle Grip
6.	S-17386	Yoke Pin	62.	S-17407	O-Ring
7.	S-17474	Spring	63.	S-18071	Pipe Plug
8.	AS-17384	Pump Link	64.	M-2071	Reservoir Cap
9.	S-17473	Link Pin	65.	S-175	Hex Hd. Cap Screw
10.	S-1699	Release Packing Nut	66.	S-18577	Name Plate
11.	S-11	Release Packing	67.	S-22960	Cylinder Cap Gasket
12.	S-1805	Pipe Plug 1/8	68.	S-15064	Handle Tube
13.	S-1700	Release Lever	69.		
14.	S-10	Ball PSE 1/4	70.	S-595	Hex Nut
15.	S-9	PSI Cup	71.	S-11563	Washer
16.	S-18	PSI Spring	72.	S-6579	Rd. Hd. Machine Screw
17.	S-7	Pressure Set Screw 1/2-20	73.	S-17468	Flat Hd. Mach. Screw
18.	S-8	Welch Plug 9/16	74.	AS-17467	Line Cover
19.	S-12580A	Packing Nut 1-1/4	75.	AS-17467A	Line Cover
20.	S-12588	Packing (3 set)	76.	AS-17439	Caster
21.	S-17383	Pump Pin	77.	S-105	Hex Hd. Cap Screw
22.	S-12774	Snap Ring	78.	AS-20603	Inner Cylinder Assembly
23.	S-12582	Pump Rod 7/8	79.	S-14110	Roll Pin
24.	S-24648	Pump Cup	80.	AS-20613	Cylinder Bearing & Sleeve
25.	S-12583	Pump Cup Washer	81.	AS-20610	Inner Cylinder
26.	S-1863	Hex Nut 5/16-24	82.	S-20621	O-Ring
27.	S-20978	Pump Tube	83.	M-2195	Upper Locking Collar
28.	S-543	Lockwasher 1/4	84.	S-20619	GT Ring
29.	S-5	Allenhead 1/4-20 3-1/2	85.	AS-20599	Column Piston Assembly
30.	S-1805	Pipe Plug 1/8	86.	S-15694	Roll Pin
31.	S-9309	Ball Chamber Plug	87.	AS-20602	Piston Bearing & Sleeve
32.	S-2594	Ball Chamber Gasket	88.	S-20598	Piston Rod
33.	S-2750	Ball 1/2	89.	AS-24507	Head Assembly
34.	S-10069	Ball Weight 1/4	90.	M-1931	Screw Knob
35.	S-2505	Ball 5/16	91.	S-12610	Tilting Screw
36.	S-15	Release Ball	92.	M-1933	Tilting Bracket
93.	S-17	Release Spring	93.	M-2274	Hinge
38.	S-6	Release Tension Screw 7/16-20	94.	S-25169	Spacers
39.	S-20	Welch Plug	95.	S-20234	Wing Nut
40.	S-17445A	Tube	96.	AS-20616	Frame Assembly
41.	S-20945	Close Nipple 1/8	97.	S-20217	Screw Pivot Bar
42.	S-20944	90° Elbow 1/4 Tube to 1/8 Pipe	98.	S-20235	Straight Link Coil Chain
43.	S-24343	O-Ring Static Seal	99.	S-20218	Swivel Pin
44.	S-17388	Intake Line	100.	S-20219	Swivel Bracket
45.	AS-20970A	Release Shaft	101.	S-12617	Roll Pin
46.	AS-20962A	Release Pedal Assembly	102.		
47.	S-595	Hex Nut 3/8-16	103.		
48.	S-20620	O-Ring	104.	AS-12606	Saddle Screw Assembly
49.	S-20988	Circuit Block	105.	S-12613	Tilting Pin
50.	S-17387A	Pump Spacer	106.	S-12615	Adapter Nut
51.	S-19909	Release Clamp Washer	107.	S-12625	Wing Nut
52.	S-3165	Cap Screw 3/8-16-1-1/2	108.	S-24503	Tilting Pin
53.	S-3277	Int. Lockwasher	109.	S-12630	Carriage Bolt
54.	S-14	Release Packing Washer	110.	AS-20439	Adapter Foot
55.	S-17384	Link	111.	AS-24490	Table Assembly
56.	S-17387	Pin Spacer			

## KJ-115 CONVERSION KIT INSTRUCTION

WA-140B Transmission Jack pump assembly can be adapted to fit model WA-140A & 140AN. KJ-115 includes all parts listed on page (29). (Kit also includes pump linkage guide).

Equipment needed to make conversion:

Welder  
8" C-Clamp  
1/4-20 Tap  
Tap Handle  
No. 8 Drill  
3/8 Drill Motor  
1/4 Transfer Punch  
10" Vise Grip

Remove old pump from unit. Clean mounting block, making sure surface is free from all burrs. Set new block assembly (item 49) on mounting block and square sides. Secure in position with C-Clamp. Using transfer punch, punch position of mounting block holes. Remove circuit block and drill with No. 8 drill. Thickness of mounting block is 3/4", drill to .650 deep. Tap holes with 1/4-20 tap. (You must have a minimum of 1/2" usable threads, to accommodate 1/4-20 by 3-1/2 socket head bolt). Clean surface and attach pump and gasket (O-ring).

Measure from point A to point B and set at 9-1/2". You are now ready to attach pump linkage guide. Slide pump linkage guide between pump pedal (item 3) and pump linkage (item 8). Position 2-1/4 dimension flush with point C and butted up to point D. Secure with C-Clamp and weld (do not allow welding to draw plate out of position). Attach dust cover (item 1) to piston stop with vise grips, leaving space between cover and pump linkage so pump linkage doesn't drag dust cover. Using transfer punch, punch hole location, remove dust cover, drill and tap holes to 1/4-20. Complete assembly; spring, line, etc.!

For further information or assistance contact Service Manager.

(Pump assembly PSI has not been factory set)

# 140B TRANSMISSION JACK

(CONVERSION KIT INCLUDES ALL ITEMS LISTED THIS PAGE)

(KJ-115)

