

INSTRUCTION MANUAL REPAIR PARTS LIST

HYDRAULIC SERVICE JACK

2 TON (1815 KG) CAPACITY

PART CODE H68053

**WARNING**

1. THIS IS A LIFTING DEVICE ONLY. THE LOAD MUST BE SUPPORTED IMMEDIATELY BY OTHER APPROPRIATE MEANS.
2. DO NOT MOVE OR DOLLY THE VEHICLE WHILE ON THE JACK.
3. DO NOT OVERLOAD. LIFT THE VEHICLE ONLY AT AREAS SPECIFIED BY THE MANUFACTURER.
4. USE ONLY ON HARD LEVEL SURFACE CAPABLE OF SUSTAINING THE LOAD.
5. CENTER LOAD ON SADDLE.
6. DO NOT OPEN OIL FILLER PLUG FOR ANY REASON UNLESS JACK IS FULLY LOWERED.
7. IT IS YOUR RESPONSIBILITY TO KEEP WARNING DECALS LEGIBLE AND INTACT. REPLACEMENT DECALS MAY BE OBTAINED FROM THE FACTORY.
8. STUDY, UNDERSTAND, AND FOLLOW ALL INSTRUCTIONS PROVIDED WITH THIS JACK PRIOR TO OPERATION.
9. FAILURE TO HEED THESE WARNINGS MAY RESULT IN LOSS OF LOAD, DAMAGE TO THE JACK, OR FAILURE RESULTING IN PROPERTY DAMAGE, PERSONAL, OR FATAL INJURY.

OWNER'S RESPONSIBILITY

Operation. The owner and/or operator shall have an understanding of these operating instructions and warnings before operating the jack. Warning information shall be emphasized and understood. If the user is not fluent in English, the instructions and warnings shall be read to and discussed with the operator in the operator's native language by the purchaser/owner, making sure that the operator comprehends its contents.

Maintenance. The jack shall be maintained in accordance with instructions listed under "Maintenance."

Inspection

1. Visual inspection shall be made before each use of the jack, checking for leaking hydraulic fluid, and damaged, loose or missing parts.
2. Each jack, if subjected to an abnormal load or shock, shall be inspected immediately by an authorized Hein-Werner service center.
3. Owners and/or users should be aware that repair of this equipment may require specialized knowledge and facilities. It is recommended that an annual inspection of the jack be made by an authorized service center and that any defective parts, decals or warning labels be replaced with genuine Hein-Werner parts. A list of authorized service centers is available upon request.

Damaged Jacks. Any jack which appears to be damaged in any way, is found to be badly worn, or operates abnormally SHALL BE REMOVED FROM SERVICE until necessary repairs are made by an authorized service center.

INSTRUCTIONS BEFORE USE

(Refer to parts illustration)

1. To prevent hydraulic fluid loss during shipment, the air vent/filler plug is closed at the factory. Prior to use, remove cover (item 4) and open air vent/filler plug (item 50) 1/2 turn counterclockwise. Replace cover.
2. Occasionally hydraulic jacks become airbound during shipment, and will not function properly. To correct this condition:
 - a. Insert handle into release valve (item 32), and turn counterclockwise. (Do not open release valve more than 3 turns.)
 - b. Place handle in handle socket (item 20) and pump handle 6-8 full strokes to purge air from the hydraulic system.
 - c. Repeat as required.
3. Thoroughly lubricate all moving parts of the jack. Raise the saddle to full height by closing release valve and pumping handle. Oil the surface of the ram as well as all moving parts in the handle and lifting mechanism.

OPERATION

1. **Lifting** - Secure vehicle by blocking wheels. Close release valve by turning handle clockwise. Dolly jack until lift saddle is centered under load and pump handle.

Always center the load on the saddle of your jack. Off-center loads and loads lifted while jack is not level may damage the jack or cause personal injury.

2. **Lowering** - Insert handle in release valve and slowly turn handle counterclockwise. **Avoid "shock loads" created by quickly opening and closing the release as the load is being lowered. This may result in overloading of the hydraulic circuit and possible damage to the jack.**

MAINTENANCE

1. Regularly check oil level. Use only genuine Hein-Werner hydraulic jack oil in the unit of your jack. Never use alcohol or hydraulic brake fluid.

To check oil level, jack must be at rest, saddle fully down. Remove air vent/filler plug and inspect oil level. Level should be between 3/16" and 1/4" below filler hole.

2. Keep the jack clean and well lubricated. Raise the saddle to full height and oil the surface of the ram often, as well as all moving parts in the pump piston and the lifting mechanism.

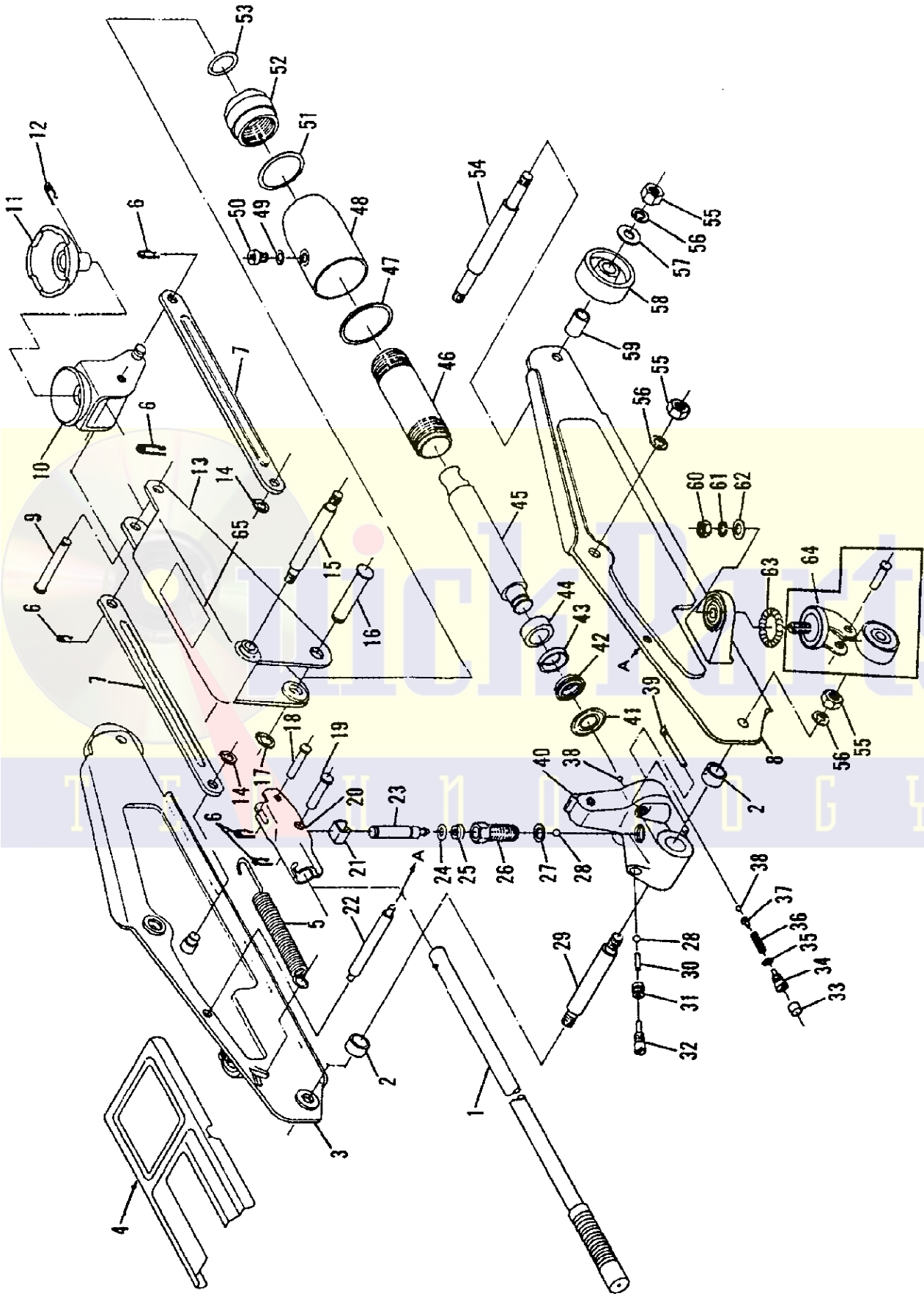

PART CODE H68053

2 TON HYDRAULIC SERVICE JACK

2 TON HYDRAULIC SERVICE JACK PART CODE H68053

Item No.	Part Code	Description	Qty. Required
1	68797	Handle	1
2	68798	Spacer	2
3	68799	Side Plate L.H.	1
4	68801	Cover	1
5	68804	Return Spring	1
6	69409	Retaining Pin	5
7	68806	Parallel Link	2
8	68807	Side Plate R.H.	1
9	68808	Pin Saddle Holder	1
10	68809	Saddle Holder	1
11	68810	Saddle	1
12	69459	Retaining Pin	1
13	68811	Lift Arm Assy.	1
14	69453	Retaining Ring	2
15	68812	Main Pivot Pin	1
16	68813	Cross Head Pin	1
17	69452	Retaining Ring	1
18	69404	Pivot Pin Handle	1
19	69408	Pin Pump Piston	1
20	68814	Handle Socket	1
21	69410	Pump Piston Clip	1
22	68815	Frame Tie Rod	1
23	68110	Pump Piston	1
24	69513	"O" Ring	1
25	68111	Piston Seal Assy.	1
26	68112	Pump Cylinder	1
27	68816	Copper Washer	1
28	69415	Ball	2
29	68817	Pivot Pin Hyd. Unit	1
30	68818	Spacer Release Valve	1
31	69420	Packing Release Valve	1
32	69418	Release Valve	1
33	69435	Valve Cap	1

Item No.	Part Code	Description	Qty. Required
34	69431	Screw Overload Valve	1
35	69433	"O" Ring Overload Screw	1
36	69432	Spring Overload Valve	1
37	69434	Spring Cap	1
38	69414	Ball	2
39	68100	Filter	1
40	68819	Base	1
41	68168	Copper Washer	1
42	69558	U-Packing Ram	1
43	69559	Back-Up Ring	1
44	69557	Spacer Ram	1
45	68820	Ram Plunger	1
46	68821	Cylinder	1
47	69566	Gasket Reservoir	1
48	68822	Reservoir	1
49	69437	"O" Ring Filler Screw	1
50	69436	Filler Plug	1
51	69565	Gasket Top Nut	1
52	69482	Top Nut	1
53	68823	"O" Ring Top Nut	1
54	68824	Front Axle	1
55	69332	Nut	6
56	68825	Spring Lock Washer	6
57	69329	Plain Washer	2
58	69327	Wheel	2
59	69335	Bushing Wheel	2
60	69496	Nut	2
61	69468	Spring Lock Washer	2
62	69466	Plain Washer	2
63	69470	Ball	28
64	68826	Rear Castor Assy.	2
65	68578	English Decal	1
	68588	French Decal	1

T E C H N O L O G Y