

INSTRUCTION MANUAL REPAIR PARTS LIST

HIGH LIFT SERVICE JACK 1-1/2 TON (1361 Kg) CAPACITY PART CODE H 28921

WARNING

1. Study, understand, and follow all warnings and instructions provided with this equipment prior to use. If any portion of this material is unclear, contact your representative or the factory for clarification. This equipment should be used only by personnel trained in its operation.
2. This equipment is designed for lifting purposes only - not for supporting loads. While lifting, position appropriate capacity vehicle stands, and extend them in stages to maintain a minimum distance between load and stands.
3. Lift only on areas of the vehicle specified by the manufacturer.
4. Do not move or dolly the vehicle while on the jack.
5. Do not overload this jack.
6. Use only on hard level surface capable of sustaining the load. Uneven surfaces can result in jack instability and possible loss of load.
7. Center load on saddle prior to lifting vehicle. Off center loads may cause damage to the jack and/or loss of load.
8. Do not open oil filler plug for any reason unless jack is unloaded and fully lowered.
9. It is the owner's responsibility to keep all warning decals and literature legible and intact. Replacement decals and literature are available from the factory.
10. Failure to heed these warnings may result in loss of load, damage to jack, or failure resulting in property damage and/or personal or fatal injury.

OWNER'S RESPONSIBILITY

Operation. The owner and/or operator shall have an understanding of these operating instructions and warnings before operating the jack. Warning information shall be emphasized and understood. If the user is not fluent in English, the instructions and warnings shall be read to and discussed with the operator in the operator's native language by the purchaser/owner, making sure that the operator comprehends its contents.

Maintenance. The jack shall be maintained in accordance with instructions listed under "Maintenance."

Inspection

1. Visual inspection shall be made before each use of the jack, checking for leaking hydraulic fluid, and damaged, loose or missing parts.
2. Each jack, if subjected to an abnormal load shock, shall be inspected immediately by an authorized Hein-Werner service center.
3. Owners and/or users should be aware that repair of this equipment may require specialized knowledge and facilities. It is recommended that an annual inspection of the jack be made by an authorized service center and that any defective parts, decals or warning labels be replaced with genuine Hein-Werner parts. A list of authorized service centers is available upon request.

Damaged Jacks. Any jack which appears to be damaged in any way, is found to be badly worn, or operates abnormally SHALL BE REMOVED FROM SERVICE until necessary repairs are made by an authorized service center.

INSTRUCTIONS BEFORE USE

1. Open release valve by turning handle counterclockwise. Pump handle six full strokes to assure proper internal lubrication, and to bleed any air from the hydraulic system.
2. Squirt a small amount of hydraulic jack oil or light-weight motor oil on the pump pistons. Pump handle several times to distribute oil.
3. Thoroughly lubricate all moving parts of the jack. Raise the saddle to full height by closing release valve and pumping handle. Oil the surface of the ram as well as all moving parts in the handle and lifting mechanism. Grease all grease fittings.

OPERATION

1. **Lifting** - Secure vehicle by blocking wheels. Close release valve by turning handle clockwise. Dolly jack until lift saddle is centered under load and pump handle.

WARNING

**USE JACK FOR LIFTING ONLY.
ALWAYS SUPPORT VEHICLE WITH
VEHICLE SUPPORT STANDS.**

Always center the load on the saddle of your jack. Off-center loads and loads lifted while jack is not level may damage the jack or cause personal injury.

2. **Lowering** - Slowly turn release handle counterclockwise. **Avoid "shock loads" created by quickly opening and closing the release as the load is being lowered. This may result in overloading of the hydraulic circuit and possible damage to the jack.**

MAINTENANCE

1. Regularly check oil level. Use only genuine Hein-Werner hydraulic jack oil in the unit of your jack. Never use alcohol or hydraulic brake fluid.

To check oil level, jack must be at rest, saddle down. Remove filler plug and inspect oil level. Level should be just over cylinder.

2. Keep the jack clean and well lubricated. Raise the saddle to full height and oil the surface of the ram often, as well as all moving parts in the handle, the pump pistons and the lifting mechanism. Frequently add grease to all fittings.

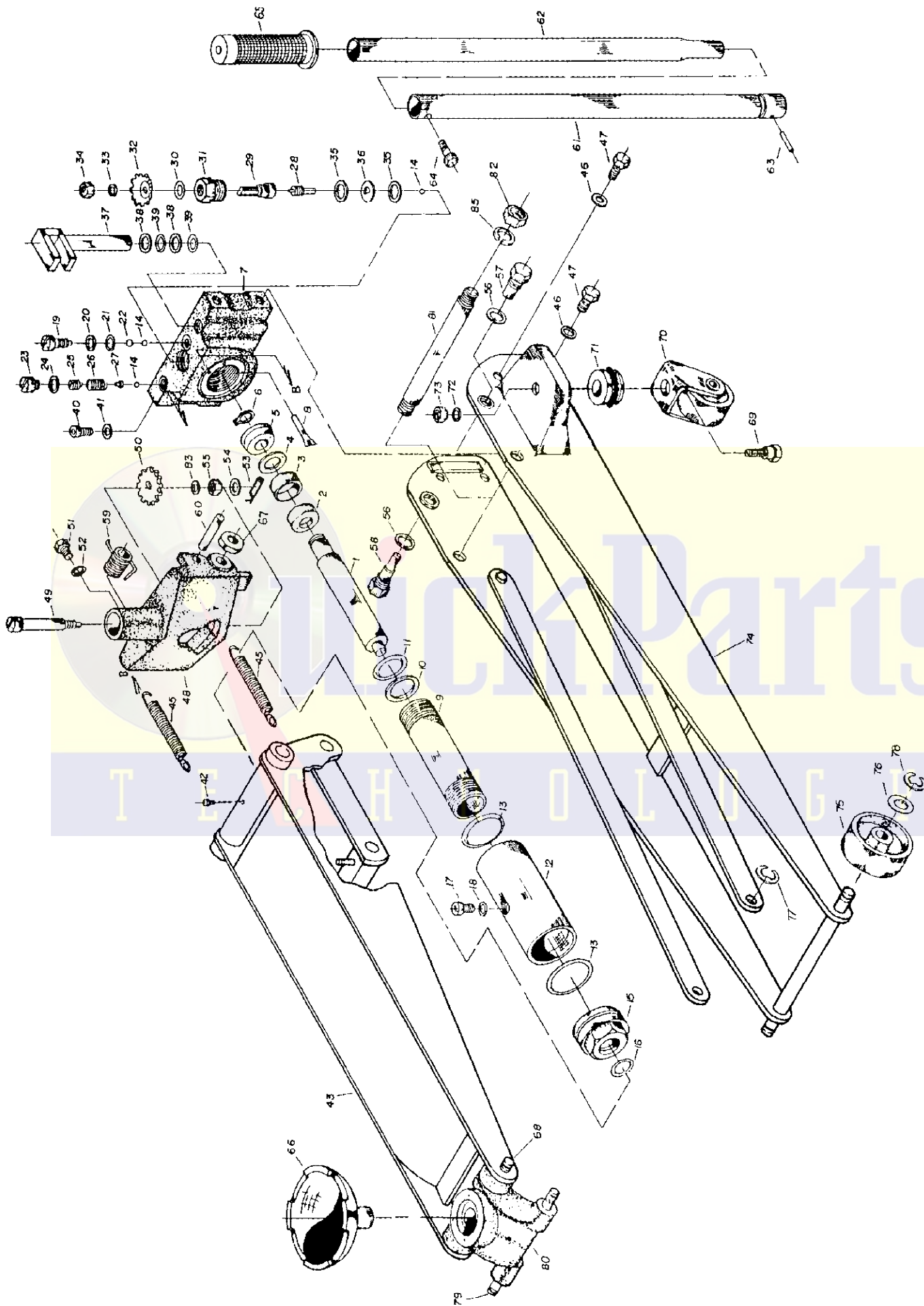

1-1/2 TON HIGH LIFT SERVICE JACK

PART CODE H 28921

**1-1/2 TON HIGH LIFT SERVICE JACK
PART CODE H 28921**

Item No.	Parts Code	Description	Qty. Required
1	H3222600	Ram Plunger	1
2	H3222400	Ram-Spacer	1
3	H6812700	Bushing Cover	1
4	H6812800	Back-Up Washer	1
5	H6812900	"U" Cup-Ram	1
6	H6945200	Retaining Ring	1
7	H3222500	Base	1
8	H6941700	Filter	1
9	H3222700	Cylinder	1
10	H6813200	Back-Up Washer	1
11	H6813300	"O" Ring	1
12	H3222800	Reservoir	1
13	H6813500	"O" Ring	2
14	H6941500	Ball 1/4"	3
15	H6813600	Top Nut	1
16	H6813700	"O" Ring Top Nut	1
17	H6813800	Filler Screw	1
18	H6943700	"O" Ring Filler Screw	1
19	H6813900	Bolt	1
20	H6814000	Washer	1
21	H6814100	"O" Ring Bolt	1
22	H6814200	Ball 3/8"	1
23	H6814300	Guard Screw	1
24	H6814400	Oil Seal	1
25	H6814500	Screw Safety Valve	1
26	H6814600	Spring	1
27	H6814700	Spring Cap	1
28	H6814800	Release Valve	1
29	H6814900	Release Valve Connecting Rod	1
30	H6815000	"O" Ring	1
31	H6815100	Release Valve Lock Nut	1
32	H6815200	Release Valve Gear	1
33	H6815300	Lock Washer	1
34	H6815400	Nut	1
35	H6815500	Nylon Packing	2
36	H6815600	Collar	1
37	H3222900	Pump Piston	1
38	H6815800	Back-Up Washer	2
39	H6815900	"O" Ring Piston	2
40	H6816000	Screw	1
41	H6816100	Washer	1
42	H6821500	Grease Fitting Nipple	1
43	H3220600	Lift Arm Assy.	1
44	H6816400	Cotter Pin	1

Item No.	Parts Code	Description	Qty. Required
45	H6816500	Return Spring	2
46	H6816600	Lock Washer	4
47	H6816700	Screw	4
48	H6816800	Handle Fork	1
49	H6816900	Release Valve Connecting Bar	1
50	H6817000	Release Valve Gear	1
51	H6817100	Screw	1
52	H6817200	Lock Washer	1
53	H6817300	Retainer	1
54	H6817400	Washer	1
55	H6817500	Nut	1
56	H6817600	Lock Washer	2
57	H6817700	Handle Bolt (A)	1
58	H6817800	Handle Bolt (B)	1
59	H6817900	Return Spring	1
60	H6818000	Pin	1
61	H6818100	Handle (I)	1
62	H6818200	Handle (II)	1
63	H6818300	Spring Pin	1
64	H6818400	Screw	1
65	H6821700	Grip-Handle	1
66	H6821800	Saddle	1
67	H6821900	Bushing	1
68	H3221400	Lift Arm Pin	1
69	H6818900	Screw	2
70	H6819000	Rear Caster Assy.	2
71	H6819100	Bearings	2
72	H6819300	Lock Washer	2
73	H6819400	Nut	2
74	H3220300	Frame Weldment	1
75	H6820200	Front Wheel	2
76	H6820300	Washer	2
77	H3221100	Snap Ring "E"	2
78	H6820500	Snap Ring "E"	2
79	H3221300	Pin-Parallel Link	1
80	H3220100	Saddle Holder	1
81	H3221700	Main Pivot Pin	1
82	H6822900	Nut	2
83	H6816200	Washer	1
84	H3220200	Hyd. Unit (not shown)	1
85	H6822800	Lock Washer	2
86	H3223000	Repair Kit (not shown)	1
	H2892300	Product Decal	1