

## INSTRUCTION MANUAL REPAIR PARTS LIST

### ⚠ WARNING

1. READ, STUDY, UNDERSTAND, AND FOLLOW ALL WARNINGS AND INSTRUCTIONS PROVIDED WITH THIS EQUIPMENT PRIOR TO USE. IF ANY PORTION OF THIS MATERIAL IS UNCLEAR, CONTACT YOUR REPRESENTATIVE OR THE FACTORY FOR CLARIFICATION.
2. NEVER ALLOW UNSKILLED OR IMPROPERLY TRAINED PERSONNEL TO OPERATE THIS EQUIPMENT.
3. THIS DEVICE IS DESIGNED FOR LIFTING PURPOSES ONLY - NOT FOR SUPPORTING VEHICLE. WHILE LIFTING, POSITION APPROPRIATE CAPACITY VEHICLE STANDS, AND EXTEND THEM IN STAGES TO MAINTAIN A MINIMUM DISTANCE BETWEEN LOAD AND STANDS. ALWAYS INSURE THAT THE LIFTS MECHANICAL LOAD HOLDING DEVICE IS FULLY ENGAGED PRIOR TO POSITIONING VEHICLE STANDS.
4. LIFT ONLY ON AREAS OF THE VEHICLE SPECIFIED BY THE MANUFACTURER.
5. DO NOT MOVE OR DOLLY THE VEHICLE WHILE ON THE JACK.
6. DO NOT OVERLOAD THIS JACK.
7. USE ONLY ON HARD LEVEL SURFACE CAPABLE OF SUSTAINING THE LOAD. UNLEVEL SURFACES CAN RESULT IN JACK INSTABILITY AND POSSIBLE LOSS OF LOAD.
8. BEFORE LIFTING, BE CERTAIN THE VEHICLE IS IN NEUTRAL, BRAKE RELEASED AND ENGINE OFF.
9. CENTER LOAD ON SADDLE PRIOR TO LIFTING VEHICLE. OFF CENTER LOADS MAY CAUSE DAMAGE TO THE JACK AND/OR LOSS OF LOAD.
10. DO NOT USE TOP OF LIFT AS A POINT OF LOADING. LIFT VEHICLE ONLY BY LIFT-BRACKETS PROVIDED ON LIFT.
11. WHEN USING THE TIRE VALVE CONNECTION TO ACTIVATE LIFT, THE INTAKE AIR VALVE LEVER IS INOPERATIVE AND THE LIFT WILL RAISE IMMEDIATELY AS AIR PRESSURE IS APPLIED.
12. DO NOT OPEN OIL FILLER PLUG FOR ANY REASON UNLESS JACK IS UNLOADED AND FULLY LOWERED.
13. CENTER LOAD ON SADDLE. UNEVEN LOAD MAY CAUSE LOAD TO SHIFT AND/OR JACK TO RISE SUDDENLY.
14. IT IS THE OWNER'S RESPONSIBILITY TO KEEP ALL WARNING DECALS AND LITERATURE LEGIBLE AND INTACT. REPLACEMENT DECALS AND LITERATURE ARE AVAILABLE FROM THE FACTORY.
15. FAILURE TO HEED THESE WARNINGS MAY RESULT IN LOSS OF LOAD, DAMAGE TO THE JACK, OR FAILURE RESULTING IN PROPERTY DAMAGE AND/OR PERSONAL OR FATAL INJURY.

B7069619

### OWNER'S RESPONSIBILITY

**Operation.** The owner and/or operator shall have an understanding of these operating instructions and warnings before operating the jack. Warning information shall be emphasized and understood. If the user is not fluent in English, the instructions and warnings shall be read to and discussed with the operator in the operator's native language by the purchaser/owner, making sure that the operator comprehends its contents.

**Maintenance.** The jack shall be maintained in accordance with instructions listed under "Maintenance."

#### Inspection

1. Visual inspection shall be made before each use of the jack, checking for leaking hydraulic fluid, and damaged, loose or missing parts.

2. Each jack, if subjected to an abnormal load or shock, shall be inspected immediately by an authorized Hein-Werner service center.
3. Owners and/or users should be aware that repair of this equipment may require specialized knowledge and facilities. It is recommended that an annual inspection of the jack be made by an authorized Hein-Werner service center and that any defective parts, decals or warning labels be replaced with genuine Hein-Werner parts. A list of authorized service centers is available from Hein-Werner.

**Damaged Jacks.** Any jack which appears to be damaged in any way, is found to be badly worn, or operated abnormally SHALL BE REMOVED FROM SERVICE until necessary repairs are made by an authorized Hein-Werner service center.

### FEATURES

1. This lift is equipped with a secondary mechanical load holding device. The load will be held in position only when this device is fully engaged. The holding device automatically engages at a number of points as the lift is raised or lowered.
2. It is also equipped with a hydraulic "check" in case the load on the lift is removed suddenly.

### OPERATING INSTRUCTIONS

#### Positioning

1. Dolly Jack to center of vehicle under bumper. Slide adjustable lifting pads an equal distance each side of center so that the pads will contact the vehicle at the frame or the bumper brackets.
2. Adjust saddle height by removing "L" shaped pin and raising or lowering as required. Be certain both saddles are at same height.
3. When lifting front end, check to see that gearshift is in neutral position and hand brake released so that vehicle may roll freely towards the Jack as the vehicle is lifted. This puts the minimum amount of strain on bumper brackets and Jack.
4. When lifting rear end, check front wheels of vehicle to see that they point straight ahead. FRONT WHEELS MUST BE ABLE TO ROLL TOWARD JACK.

#### Lifting

1. Open air valve slowly to allow pads to make contact with vehicle. Lift will drift up slightly when valve is released.

- Open valve and raise to desired height. The mechanical lock will engage automatically at intervals while Jack is being raised.

### Lowering

In order to release Jack and remove weight from mechanical lock, apply small amount of air. Lift mechanical locking handle and release lock. Release air by operating valve and hold mechanical lock in off position. The speed of descent is governed by air valve and the operator has the ability to regulate the desired rate of descent.

## MAINTENANCE INSTRUCTIONS

### LUBRICATION

- Grease front lifting roller weekly.
- All mechanical parts should be oiled every 60 days.
- If air cylinder needs lubrication, clean with solvent and apply a light coat of chassis grease.

### Air Cylinder

Water from compressed air may accumulate in air cylinder. To drain, remove air valve and tip jack to allow water to drain out.

### Hydraulic Damper

The hydraulic damper is factory set, and should not require adjustment. We recommend (at least once each month) the following test be performed to check the effectiveness of the unit.

#### To Test Hydraulic Damper

- Lower lift all the way down.
- Stand clear.
- With no load - Apply full air.
- Lift should rise smoothly.
- Damper is low on oil if it rises suddenly a short distance - then continues at a smooth slow rise.

If the unit appears to be defective, then the lift should be inspected and repaired by an authorized Service Center.

### 5 Ton End Lift Model AL-50-1

Item No.	Part Code	Description	Qty. Required
1	BK121100	Spring	1
2	BK220039	Bushing	2
3	BK171110	Bracket	1
4	BK122108	Washer	1
5	BK289044	Ring	5
6	BA489900	Pin w/Chain	2
7	BK104626	Arm	2
8	BK111626	Saddle	2
9	BK225186	Spacer	2
	AJ100207	Bolt	4
	SJ100415	Washer	4
10	BS418820	Fitting	1
11	BK201268	Spacer	1
12	BK200039	Bushing	2
13	BK202281	Roller	1
14	BK338108	Washer	1
15	BK285055	Nut	1
16	BO300083	Nut	5
17	BK359000	Tank	1
18	BK286028	Bolt	1
*19	BK288041	O-ring	1
20	BK224020	Cap, Top	1
21	BJ168291	Elbow	2
22	BK203096	Pipe	1
23	BK919000	Valve	1
24	BK206626	Cover w/Handles	1
25	BD235055	Nut	2
26	BK222055	Nut	1
27	BK230108	Washer	1
28	BK223108	Washer	1
29	BK124149	Rod	1
*30	BK125041	Cup	2
31	BK131020	Cap	1
*32	BK106041	O-ring	2
33	BS111900	Washer	1
34	BS415600	Ball	1
35	BK128051	Piston	1

Item No.	Part Code	Description	Qty. Required
36	BK127030	Cylinder	1
37	EJ100014	Nut	2
38	EJ100012	Washer	2
*39	BD385041	Cup	2
40	BK129071	Follower	1
41	BK130020	Cap	1
42	BK118101	Plate	2
43	BK119106	Wheel	2
44	BE189108	Washer	2
45	BK170010	Frame	1
46	BK121108	Washer	1
47	BK420610	Stem	1
48	BE169106	Caster	1
49	BK147242	Bolt	2
50	BK287028	Bolt	2
51	BJ606291	Elbow	2
52	BK132900	Damper, Hydraulic	1
53	BK126268	Tube	1
*54	BJ774041	O-ring	1
*55	BK219044	Spacer	1
56	BK218626	Piston	1
*57	BK221041	Cup	1
58	BK567550	Grip	2
59	BK602800	Bolt	4
	BD256108	Washer	4
60	BK214149	Rod, Release	1
61	BW401080	Washer	2
	BK185800	Pin	2
62	BK213626	Latch	1
	BB239061	Pin	1
63	BK209626	Shaft	1
64	BK284028	Bolt	1
Not Shown	H6528100	Decal (Air Valve)	1
Not Shown	H2866400	Decal (Warning)	1
Not Shown	H2872400	Decal (Product)	1
Not Shown	H6693900	HW Logo Decal	1
Not Shown	B67440X0	Repair Kit	1

\* Included in B67440X0 Repair Kit  
Order by Part Code

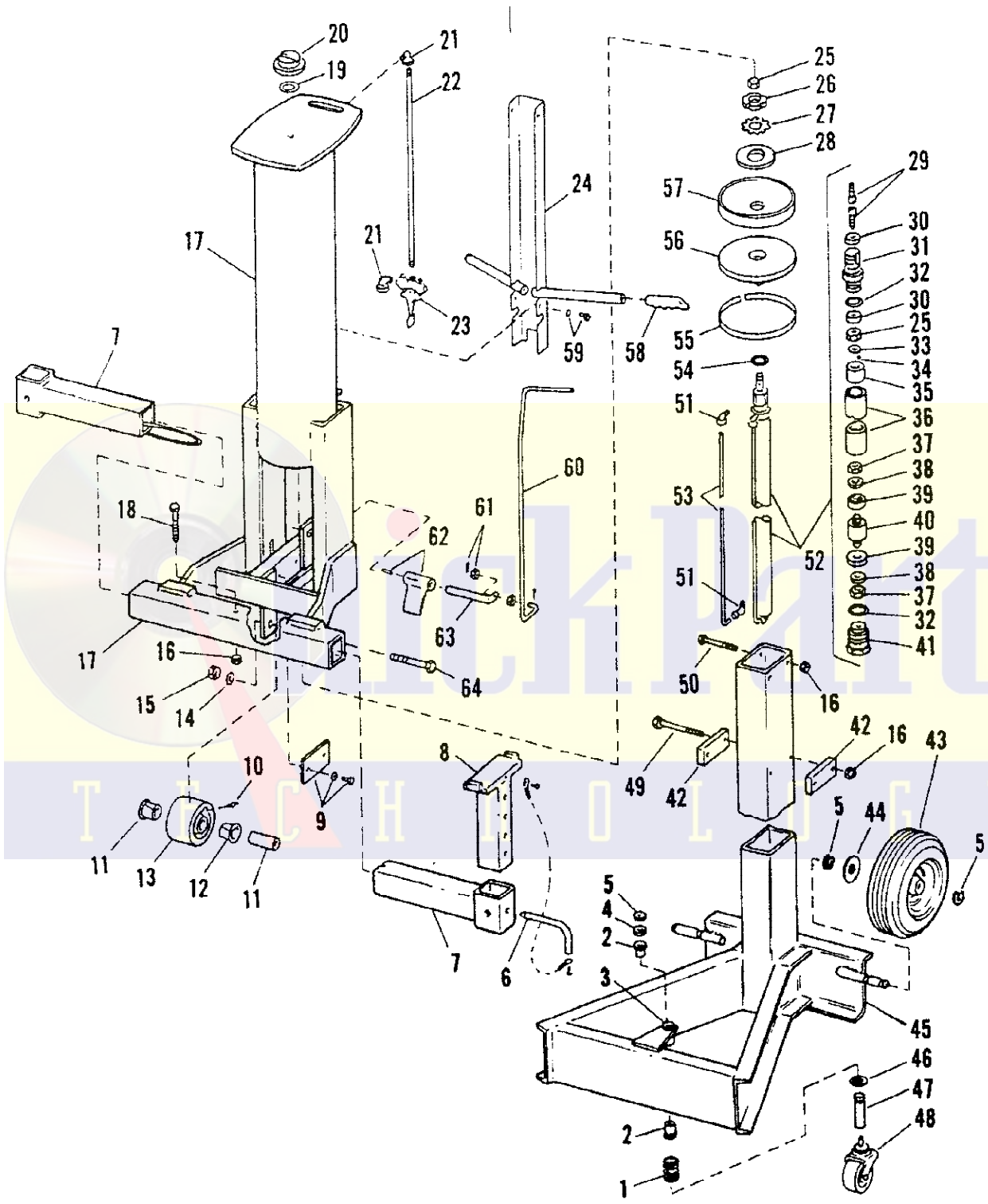

Model AL-50-1