

### TRANSMISSION JACK 1000 LB (454 Kg) CAPACITY MODEL B67554

#### **▲ WARNING**

1. READ, STUDY AND UNDERSTAND ALL WARNING LABELS AND OPERATING INSTRUCTIONS FURNISHED WITH THIS EQUIPMENT PRIOR TO USE. IF ANY PORTION OF THIS MATERIAL IS UNCLEAR, CONTACT YOUR REPRESENTATIVE FOR CLARIFICATION.
2. NEVER ALLOW UNSKILLED OR IMPROPERLY TRAINED PERSONNEL TO OPERATE THIS EQUIPMENT.
3. USE OF THE TRANSMISSION JACK IS LIMITED TO THE REMOVAL AND INSTALLATION OF TRANSMISSIONS, TRANSAXLES AND VEHICLE COMPONENTS FOR WHICH APPROPRIATE ADAPTORS ARE SUPPLIED. DO NOT LIFT OR SUPPORT VEHICLES WITH TRANSMISSION JACK.
4. BE SURE VEHICLE IS APPROPRIATELY SUPPORTED BEFORE STARTING REPAIRS. THIS JACK IS NOT A LOAD SUSTAINING DEVICE.
5. DO NOT OVERLOAD. OVERLOAD CAN CAUSE DAMAGE, FAILURE OF THE JACK AND/OR PERSONAL OR FATAL INJURY.
6. USE ONLY ON HARD LEVEL SURFACES CAPABLE OF SUSTAINING THE LOAD. USE ON OTHER THAN HARD LEVEL SURFACES WILL RESULT IN JACK INSTABILITY AND LOSS OF LOAD.
7. ALWAYS USE THE LOAD RESTRAINT CHAIN, CORNER SUPPORT BRACKET, AND ATTACHMENTS TO STABILIZE AND FIRMLY SECURE THE LOAD TO THE SADDLE. INSURE LOAD RESTRAINT CHAIN IS TIGHT AND PROPERLY POSITIONED TO EFFECTIVELY HARNESS THE LOAD. NEVER USE THIS JACK WITHOUT A LOAD RESTRAINT CHAIN STRONG ENOUGH TO SUPPORT THE TRANSMISSION.
8. PRIOR TO TRANSPORTING THE LOAD, INSURE THAT THE JACK IS ADJUSTED SO THE SADDLE IS IN THE LOWEST HORIZONTAL POSITION POSSIBLE, AND THE LOAD IS CENTRALLY LOCATED ON THE SADDLE.
9. DO NOT MODIFY THIS EQUIPMENT OR REMOVE LOAD RESTRAINT CHAINS.
10. IT IS YOUR RESPONSIBILITY TO KEEP ALL WARNING LABELS AND INSTRUCTIONAL LITERATURE LEGIBLE AND INTACT. REPLACEMENT LABELS AND LITERATURE ARE AVAILABLE FROM THE FACTORY.
11. FAILURE TO HEED THESE WARNINGS MAY RESULT IN EQUIPMENT AND/OR PROPERTY DAMAGE AND/OR PERSONAL OR FATAL INJURY.

#### OWNER'S RESPONSIBILITY

**Operation.** The owner and/or operator shall have an understanding of these operating instructions and warnings before operating the jack. Warning information shall be emphasized and understood. If the user is not fluent in English, the instructions and warnings shall be read to and

discussed with the operator in the operator's native language by the purchaser/owner, making sure that the operator comprehends its contents.

**Maintenance.** The jack shall be maintained in accordance with instructions listed under "Maintenance."

#### Inspection

1. Visual inspection shall be made before each use of the jack, checking for leaking hydraulic fluid, and damaged, loose or missing parts.
2. Each jack, if subjected to an abnormal load or shock, shall be inspected before reuse by an authorized Blackhawk service center.
3. Owners and/or users should be aware that repair of this equipment may require specialized knowledge and facilities. It is recommended that an annual inspection of the ram be made by an authorized Blackhawk service center and that any defective parts, decals or warning labels be replaced with genuine Blackhawk parts. A list of authorized service centers is available from Blackhawk.

**Damaged Jacks.** Any jack which appears to be damaged in any way, is found to be badly worn, or operates abnormally SHALL BE REMOVED FROM SERVICE until necessary repairs are made by an authorized Blackhawk service center.

#### Instructions Before Use

1. Remove breather plug and check oil level - it should be up to the hole. Fill if necessary with clean Blackhawk hydraulic jack oil.
2. Many jacks become "air bound" in transit. Before using jack for the first time, it may be necessary to bleed the hydraulic system.

**To Remove Air From The Pump** - With the release lever depressed, hand pump several times to expel excess air from the piston area. It should then be possible to raise the rams with normal hand pump action.

**To Remove Air From The Rams** - Pump up unit until small ram is extended approximately 6". Lift off the adapter and carrier assembly from the top of the small ram. Back off the large slotted screw down inside the hole in the top of the ram until all the air is expelled when oil begins to seep out past the slotted screw, then close the slotted screw.

**HYDRAULIC POWER UNIT K13900**

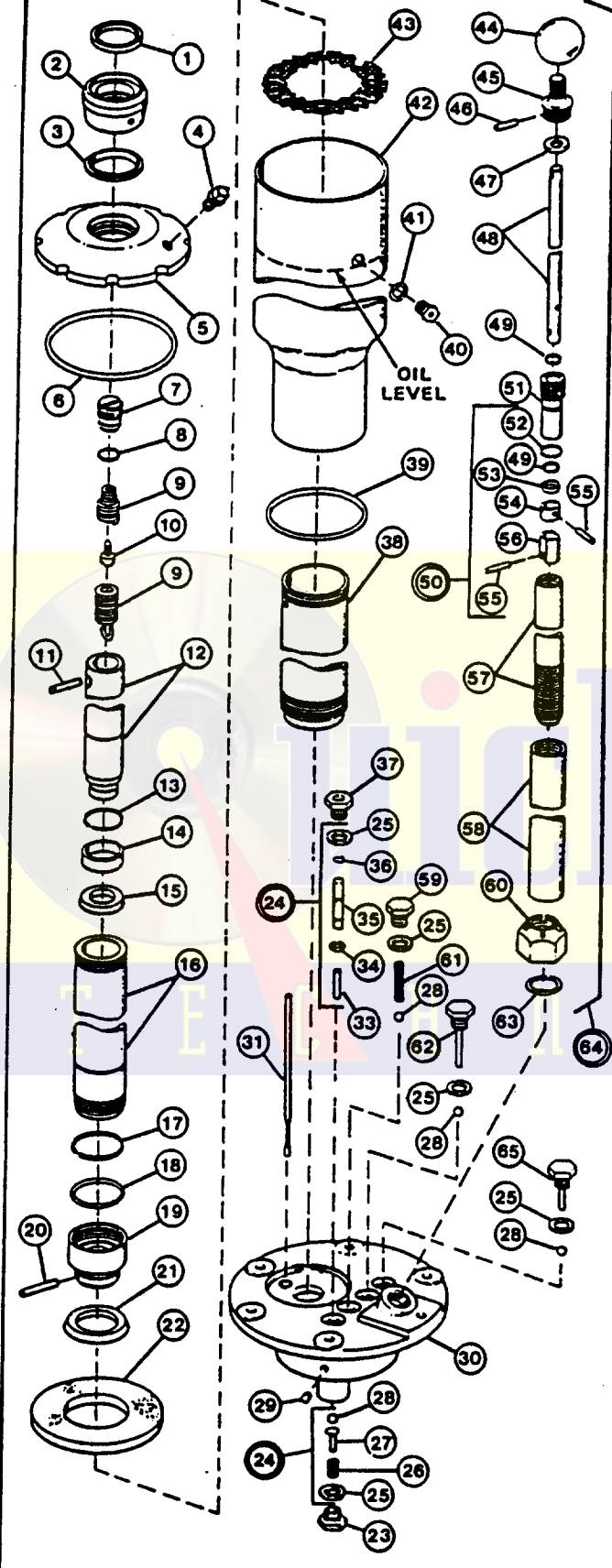

**UPPER CARRIER TK-320-2**

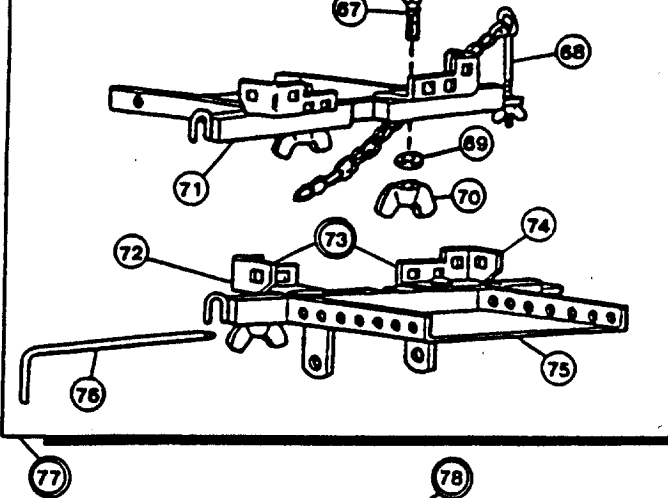

**LOWER CARRIER TK-700**

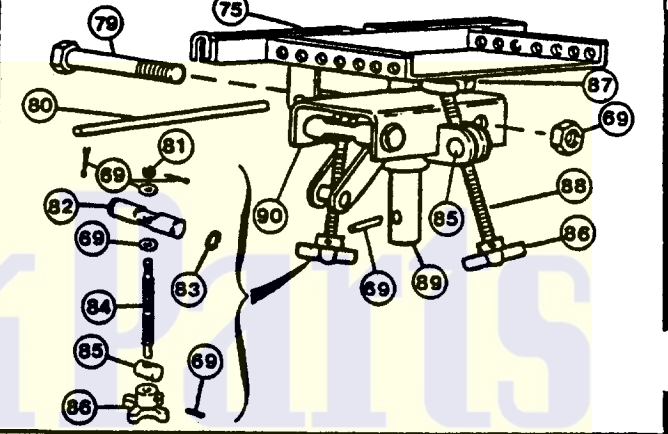

**ADDING OIL**  
Remove plug (40) and add oil to indicated level.

**PURCHASE COMMON HARDWARE LOCALLY**

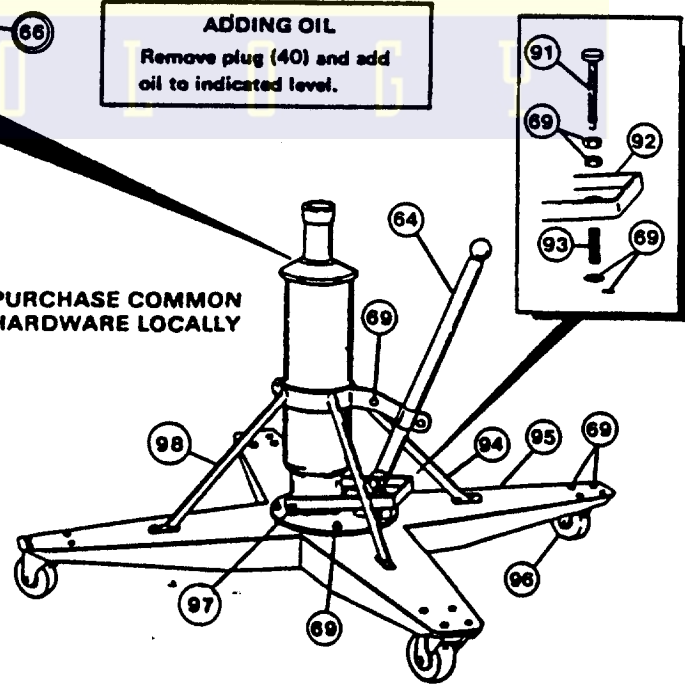

## MAINTENANCE

If hand pump stroke is only partially effective or the ram seems spongy, the oil level in the power unit may be low or there may be air in the power unit.

### 1. To Add Oil:

- a. Lower jack to full down position.

- b. Remove filler plug in top cap.
- c. Add hydraulic jack oil. **DO NOT USE HYDRAULIC BRAKE FLUID**, it will damage hydraulic seals. (Transmission oil will cause slow retraction of rams) and void warranty.
- d. Fill reservoir to height of vent on side of reservoir.

## TRANSMISSION JACK MODEL B 67554

Item No.	Part Code	Description	Qty. Required	Item No.	Part Code	Description	Qty. Required
• 1	BA730394	Cap Wiper	1	•54	BJ766814	Fixed Valve	1
2	BJ757020	Top Cap	1	•55	BD674061	Pin	2
• 3	BJ756041	Plunger Wiper	1	•56	BJ767814	Sliding Valve	1
4	BD149006	Pipe Plug	1	57	BJ769268	Pump Tube	1
5	BJ755055	Reservoir Cap	1	58	BJ768446	Pump Sleeve	1
• 6	BD197041	Nut "O" Ring	1	59	BE810060	Overload Plug	1
7	BJ748006	Spring Anchor	1	60	BJ658055	Pump Nut	1
• 8	BJ711041	Anchor "O" Ring	1	•61	BD151183	Overload Spring	1
9	BJ791110	Plunger Spring	1	62	BD138006	Intake Plug	1
10	BK310280	Anchor Screw	1	•63	BD669041	"O" Ring, 7/8"	1
11	30400026	Spring Pin	1	64	BJ770900	Pump	1
12	BJ758040	Inner Plunger	1	65	BD905900	Check Ball Plug	1
13	BJ700044	Inner Stop Ring	1	66	245046	Power Unit	1
14	EJ100022	Plunger Ring	1	67	BD274028	Corner Bolt	4
•15	BK330410	Inner Plunger Cap	1	68	BD975900	Chain & Bolt Assy.	1
6	BJ752040	Outer Plunger	1	69	BU31X500	Hardware Kit	1
•17	BJ363044	Outer Stop Ring	1	70	BD263055	Wing Nut	4
•18	BJ774041	"O" Ring	1	71	245051	Top Plate	1
19	BJ749040	Plunger Extension	1	72	245047	L.H. Corner Bracket	2
20	BK268061	Extension Pin	1	73	BTK32300	4 Corner Set w/Hardware	1
•21	BJ750041	Outer Plunger Cap	1	74	245048	R.H. Corner Bracket	2
22	BD665018	Filter	1	75	245052	Bottom Plate	1
23	BD167006	Release Plug	1	76	BD106061	Location Pin	1
•24	BU31X300	Release Kit	1	77	BTK320-2	Upper Carrier	1
•25	BD144167	Gasket	5	78	BTK70000	Lower Carrier	1
•26	BD154183	Guide Spring	1	•79	D120028-1	Hex Head Cap Screw	1
•27	BJ762013	Ball Guide	1	80	BD119061	Hinge Pin	1
•28	BW121600	3/8" Ball	4	81	BD268055	Side Tilt Nut	1
29	BD190006	Base Plug	5	82	BD117055	Pivot Nut	1
30	BK210050	Base (Less Item 29)	1	83	BD222044	Retaining Ring	2
31	BD667268	Oil Tube	1	84	BD113028	Side Tilt Screw	1
•33	BK706100	Release Pin	1	85	BD920550	Pivot Nut	2
•34	BD153044	Shaft Ring	1	86	BD935500	Tilt Knob	2
•35	BD140040	Release Shaft	1	87	BD121151	Screw Retainers	1
•36	BB709503	Shaft "O" Ring	1	88	BD118028	Tilt Screw	1
37	BD139039	Release Bushing	1	89	245050	TK700 Stem	1
38	BJ753030	Cylinder	1	90	245049	TK700 Saddle	1
•39	BD145041	Base "O" Ring	1	91	BD185028	Treadle Screw	1
40	AJ100060	Filler Plug	1	92	BD163218	Treadle	1
•41	AJ100020	Gasket	1	•93	BD183183	Treadle Spring	1
42	BJ754025	Reservoir	1	94	245045	L.H. Brace	1
43	BD666018	Screen	1	95	95081846	Base Frame	1
44	BP603080	Pump Knob	1	96	BK515400	Caster	4
45	BD134151	Piston Anchor	1	97	BD162151	Release Swivel	2
•46	BD374061	Anchor Pin	1	98	245044	R.H. Brace	1
47	B5750000	Pump Packing	1	†	BTK32500	Power Glide Adapter	1
48	BJ764040	Pump Piston	1	†	B67554U0	Repair Kit	1
•49	BB710503	"O" Ring, 1/2"	2	†	BK550640	Decal, Product	1
•50	BU31X400	Pump Kit	1	†	H2800500	Decal, Warning	1
51	BJ765013	Retainer	1	†	BE772026	Decal, Instruction	1
•52	BD671041	"O" Ring, 3/4"	1	†	415169	Nameplate	1
•53	BJ614108	Nylon Bumper	1				

• Available individually or in kit #B 67554U0.

† Not Shown.

## TROUBLESHOOTING

### Cause — Solution

Jack will not lift load	Jack lowers under load	Jack will not lift full rated capacity	Pump feels spongy	Jack will not lift full height	Jack will not lower completely	
✓			✓	✓		Jack may be low on oil. Remove filler screw and fill reservoir with clean Blackhawk jack oil.
✓			✓	✓	✓	Reservoir is not properly vented. Make sure solid filler screw has been replaced with vented screw.
✓		✓	✓	✓		Jack may be airbound. Bleed the hydraulic system. See "Maintenance."
✓	✓	✓				Valves may not be closing properly. Flush valves by standing on legs and pulling up on saddle.
				✓		Rams may be corroded or dirty. Clean, polish, and lubricate.
	✓	✓				Release valve may not be sealing. Release lever should operate freely.
	✓					External leakage - take to Blackhawk service center.

If the above procedures do not remedy the problem — the jack will require service and should be taken to an Authorized Blackhawk Service Center for repair.

### LIMITED WARRANTY

Lincoln, a division of McNeil (Ohio) Corp., a subsidiary of Pentair, Inc., warrants that jacks and related service equipment sold with the brandnames Lincoln, Blackhawk Automotive, Blackhawk Automotive Banner, Blackhawk Automotive Porto-Power, Hein Werner Automotive, Hein Werner Automotive Winner will be free from defects in material and workmanship during one (1) year following the date of purchase. This warranty is extended to the original retailer purchaser only. If a jack or related service equipment proves to be defective during this warranty period, it will be prepaid or replaced without charge. To obtain repair or replacement, it must be shipped, transportation charges prepaid, with proof of date of purchase to a Lincoln authorized Warranty and Service Center, within one (1) year following the date of purchase. This warranty does not apply to parts damaged from accident, overload, or abuse, nor does it apply to any equipment which has been altered or used with special attachments other than those recommended by Lincoln. No other express warranty applies to jacks and related service equipment manufactured by Lincoln.

**ANY IMPLIED WARRANTIES** applicable to jacks and related service equipment manufactured by Lincoln, **INCLUDING THE WARRANTIES OF MERCHANTABILITY AND FITNESS FOR A PARTICULAR PURPOSE, WILL LAST ONLY FOR ONE (1) YEAR FROM THE DATE OF PURCHASE. SOME STATES DO NOT ALLOW LIMITATIONS ON HOW LONG AN IMPLIED WARRANTY LASTS, SO THE ABOVE LIMITATION MAY NOT APPLY TO YOU.**

In no event shall Lincoln be liable for incidental or consequential damages. The liability of Lincoln on any claim for loss or damage arising out of the sale, resale, or use of a jack or related service equipment shall in no event exceed the purchase price.

**SOME STATES DO NOT ALLOW THE EXCLUSION OR LIMITATION OF INCIDENTAL OR CONSEQUENTIAL DAMAGES, SO THE ABOVE LIMITATION OR EXCLUSION MAY NOT APPLY TO YOU.**

**THIS WARRANTY GIVES YOU SPECIFIC LEGAL RIGHTS, AND YOU MAY ALSO HAVE OTHER RIGHTS WHICH VARY FROM STATE TO STATE.**

**BLACKHAWK AUTOMOTIVE**  
IS A LICENSED TRADEMARK.  
**LINCOLN AUTOMOTIVE**  
St. Louis, Missouri 63120-1578  
Customer Service (314) 679-4300